



US 50 PURCELL INTERCHANGE



A rendering of the completed interchange

PROJECT OVERVIEW

The Colorado Department of Transportation started the first phase in the construction of a new interchange at US Highway 50 and Purcell Boulevard in Pueblo West in August.

This phase of the project includes lengthening the third westbound travel lane of US 50 between Pueblo Blvd. and Purcell Blvd. and construction of on- and off-ramps on the east side of Purcell Blvd.

These improvements, which include the addition of sidewalks, curbs and gutters, will significantly increase safety on a roadway that carries a high volume of traffic, reduce commuting times for area residents, and allow pedestrians to safely navigate the intersection.

PROJECT PROGRESS

- Construction of 2-mile barrier from Pueblo Blvd. to Purcell Blvd on westbound US 50 and near Purcell Blvd. on eastbound US 50
- Traffic shift on northbound Purcell Blvd. in preparation for ramp construction and other improvements

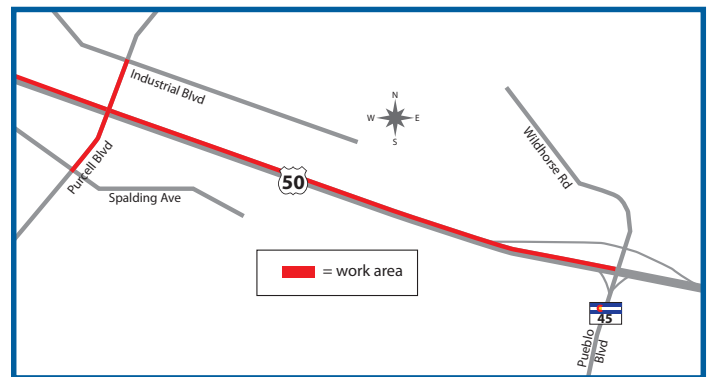

UPCOMING WORK

- Extensive grading and excavation
- Placement of embankment and base course materials
- Placement of concrete
- Installation of temporary signals and lighting
- Asphalt paving

(continued on other side)

Email: US50Pueblo@PublicInfoTeam.com
Phone: 719-789-5099
Web: codot.gov/projects/us50interchange
Traffic Alerts: Text **US50Purcell** to **313131***



*Message and data rates may apply. Reply STOP to opt out. Terms of Use. Privacy Policy.

US 50 PURCELL INTERCHANGE CONSTRUCTION UPDATE

November 2020

Public Information Manager
c/o ZoZo Group, LLC
2590 N. Washington St.
Denver, CO 80205



COLORADO
Department of Transportation

US 50 PURCELL INTERCHANGE

(continued from other side)

SCHEDULE AND WORK HOURS

Work is expected to continue through spring of 2022.

Normal working hours will be from 7 a.m. to 7 p.m. Monday through Friday. Work during overnight hours can be expected during some phases of the project.

TRAFFIC IMPACTS

The first traffic shift on Purcell Blvd. has moved northbound travel lanes into a final configuration. Motorists can anticipate a second traffic shift for southbound Purcell Blvd. in summer of 2021.

A right shoulder closure is in place on eastbound US 50 near Purcell Blvd. to allow room for the construction of on-and-off-ramps. A right shoulder closure is in place on westbound US 50 from Pueblo Blvd. to just west of Purcell

CONSTRUCTION UPDATE



Crews conducting earth work along westbound US 50.

Blvd. These shoulder closures will remain in place 24 hours a day through much of the project.

Speed limits on US 50 through the construction zone have been reduced to 55 miles an hour. Motorists should be alert to crews working near the roadway. When appropriate, flaggers will direct motorists through work performed on roadways. Slight delays can be expected.

CONTACTING THE PROJECT TEAM

If you have questions about the project, or would like to be notified of upcoming closures, please contact the Public Information Team. We will respond within 24 business hours.